

BIKE ALARM AND FINDER

QUICK START GUIDE

CONTENTS

1. WHAT'S IN THE BOX
2. ENABLE PAIRING
3. SET-UP KNOG APP
4. CONNECT & REGISTER DEVICE
5. ARMING & DISARMING SCOUT
6. FIRMWARE UPDATES
7. CONNECTING TO Find My
8. CHARGING
9. MOUNTING
10. DISABLE Find My
11. FACTORY RESET
12. SERIAL NUMBER LOOK-UP

WHAT'S IN THE BOX 1

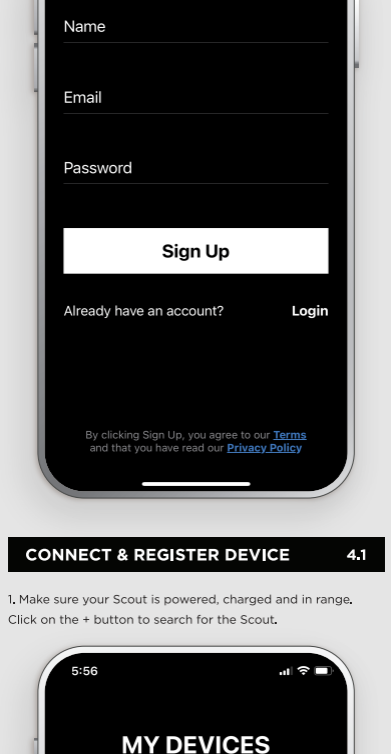

ENABLE PAIRING 2

Before you can pair the Scout to your phone, connect the Scout to a USB charging port via a standard USB-C cable. Once the Scout is connected you will hear a 3-tone beep.

**If the Scout was previously linked to another Knog mobile account or Apple ID, make sure that it has been removed from accounts via the Knog Mobile and Find My apps, then perform a factory reset of the Scout as described on step 11.*

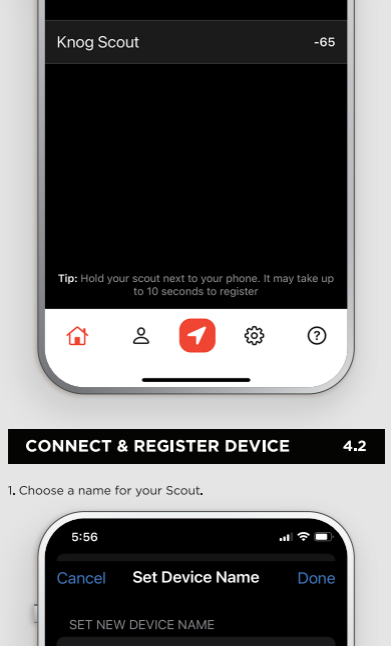

SET-UP KNOG APP 3

1. Find and install the Knog app from the app store.

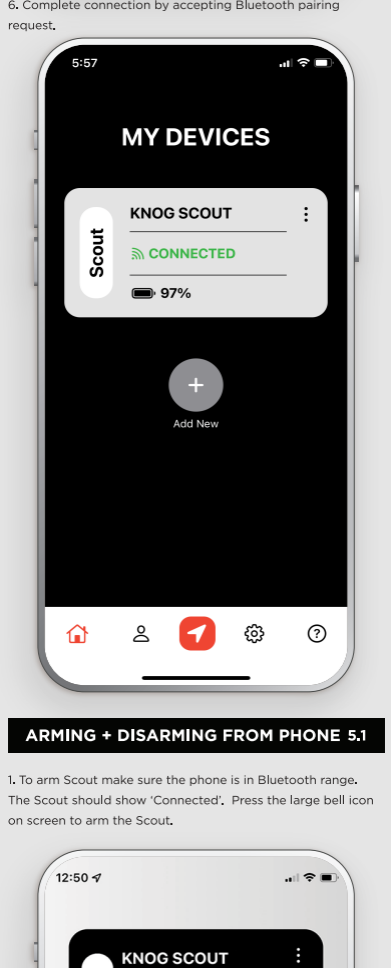

2. Enter your information to create your profile.

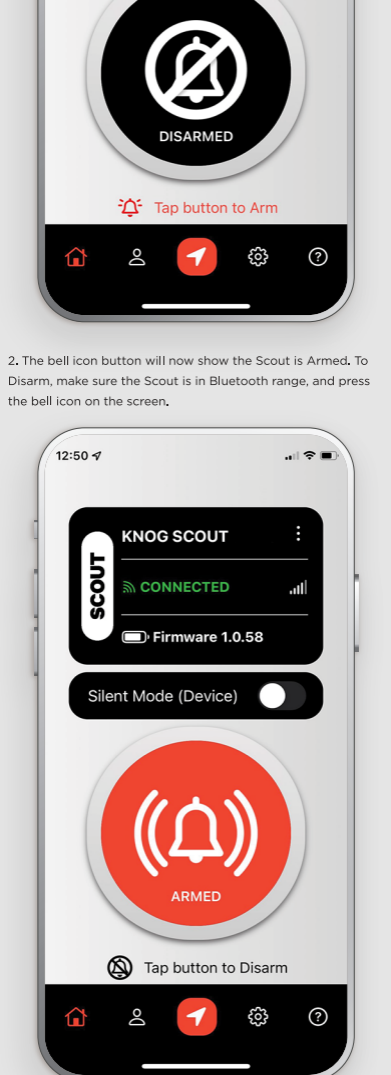

CONNECT & REGISTER DEVICE 4.1

1. Make sure your Scout is powered, charged and in range. Click on the + button to search for the Scout.

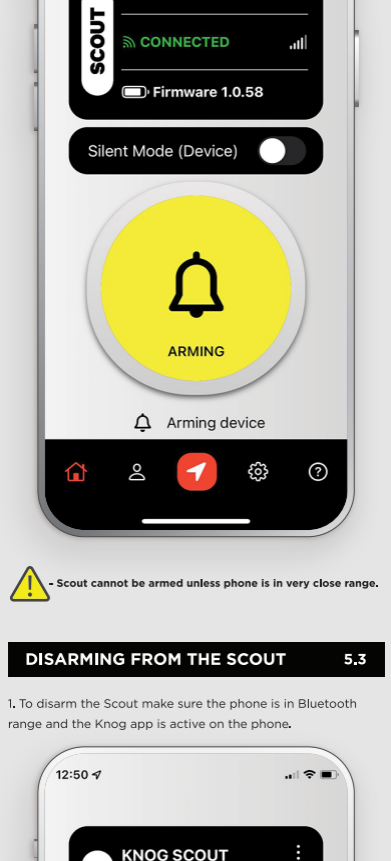

2. Select device to add "Knog Scout".



CONNECT & REGISTER DEVICE 4.2

1. Choose a name for your Scout.

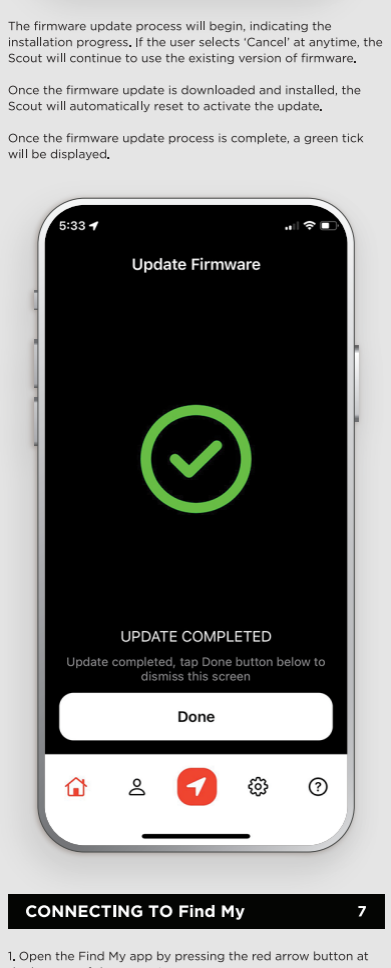

6. Complete connection by accepting Bluetooth pairing request.

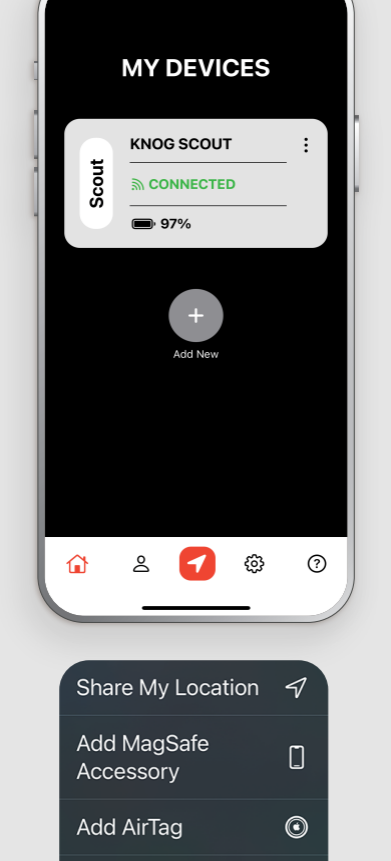

ARMING + DISARMING FROM PHONE 5.1

1. To arm Scout make sure the phone is in Bluetooth range. The Scout should show 'Connected'. Press the large bell icon on screen to arm the Scout, a message "You are up to date" will be displayed.



2. The bell icon button will now show the Scout is Armed. To Disarm, make sure the Scout is in Bluetooth range, and press the bell icon on the screen.

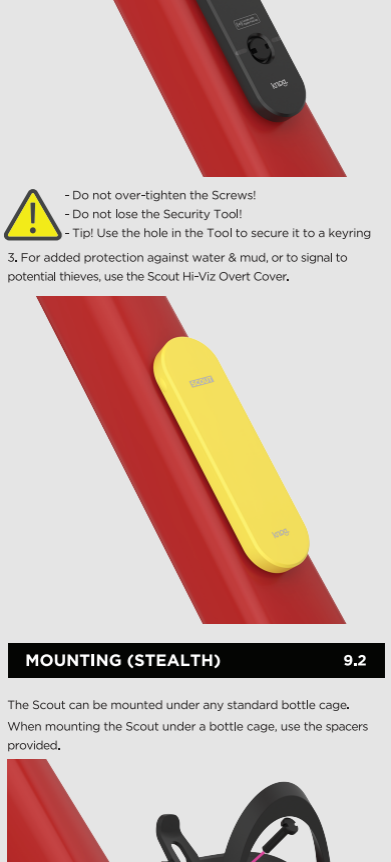

ARMING FROM THE SCOUT 5.2

1. To arm the Scout, make sure the phone is in Bluetooth range and the Knog app is active.

2. Press and hold the button on the Scout to begin arming.



Whilst arming, the Scout LEDs will flash red and the bell icon will appear yellow.

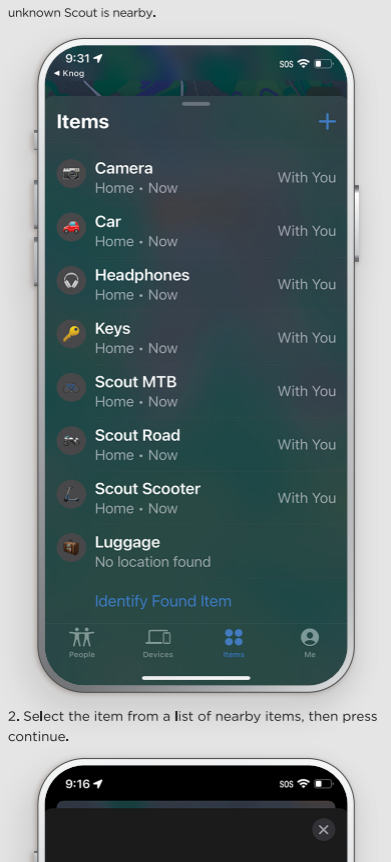

⚠️ Scout cannot be armed unless phone is in very close range.

DISARMING FROM THE SCOUT 5.3

1. To disarm the Scout make sure the phone is in Bluetooth range and the Knog app is active on the phone.

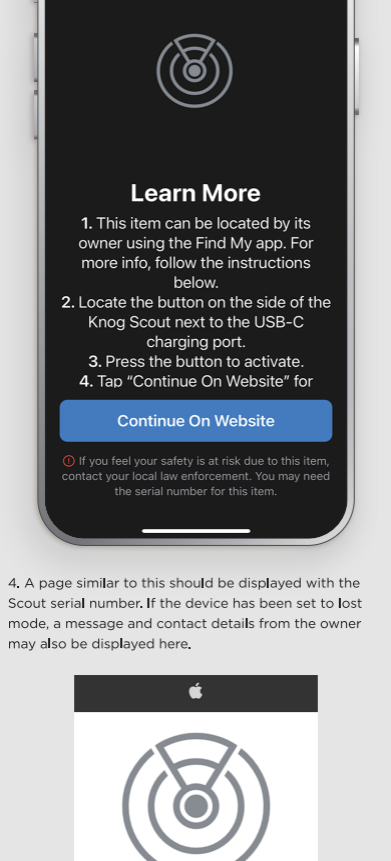

2. Press and hold the button on the Scout to disarm it.

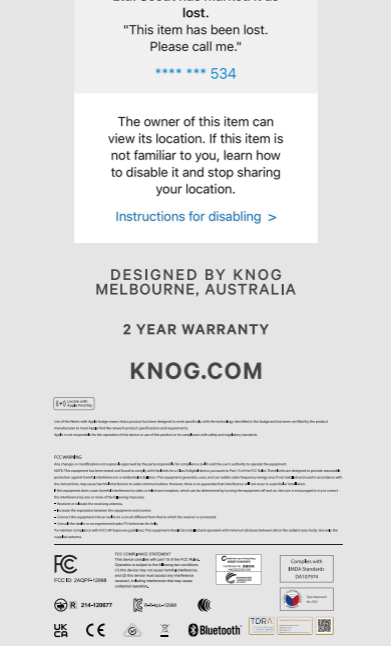

⚠️ Scout cannot be disarmed unless phone is in very close range.

FIRMWARE UPDATE 6

Once the Scout is connected, inside the app select the 3 dots for more options. Scroll down, and select 'Update Firmware'. If the device has the most up-to-date firmware already installed, a message "You are up to date" will be displayed.

If a firmware update is available, download and install it to the Scout.

The firmware update process will begin, indicating the installation progress, if the user selects "Cancel" at anytime, the Scout will continue to use the existing version of firmware.

Once the firmware update is downloaded and installed, the Scout will automatically reset to activate the update.

Once the firmware update process is complete, a green tick will be displayed.

CONNECTING TO Find My 7

1. Open the Find My app by pressing the red arrow button at the bottom of the screen.

**To use the Apple Find My app to locate this item, the latest version of iOS, iPadOS, watchOS, or macOS is recommended.*

2. Press 'Add New Item'

3. Select 'Add Other Item'

4. When the Scout appears, press to connect to Find My. Select and name your Scout.

CHARGING 8

1. Open USB door seal.

2. Plug in USB-C charging cable, Red LED indicates charging.

3. Green LED indicates fully charged.

MOUNTING (OVERT) 9.1

The Scout can be mounted to any standard bottle cage location.

1. Place the Scout on your bike, aligning the holes with screw bosses, then insert the screws.

2. Use the Scout Security tool to tighten and secure the screws.

⚠️ Do not over-tighten the screws!
⚠️ Do not lose the Security Tool!

⚠️ Tip! Use the hole in the Tool to secure it to a keyring

3. For added protection against water & mud, or to signal to potential thieves, use the Scout Hi-Viz Overt Cover.

MOUNTING (STEALTH) 9.2

The Scout can be mounted under any standard bottle cage.

When mounting the Scout under a bottle cage, use the spacers provided.

DISABLE Find My 10

If an unfamiliar Knog Scout is found in your possession, the owner of the item can view it's location. Once the Knog Scout serial number has been identified, follow the "instructions for disabling" link to disable Find My.

1. Turn the Scout upside down and place on an horizontal surface.

2. Press and hold the button, while plugging in a USB-C cable. Continue to hold the button for 30 seconds, until 4 short beeps are heard.

This procedure will stop sharing the location of the Scout.

FACTORY RESET 11

1. Turn the Scout upside down and place on an horizontal surface.

2. Press and hold the button, while plugging in a USB-C cable. Continue to hold the button for 10 seconds, until 3 long beeps are heard.

SERIAL NUMBER LOOK UP 12

The Apple Find My app can be used to look up the serial number of an unknown Scout in your possession.

1. In the Find My app, select Identify found item, when the unknown Scout is nearby.

2. Select the item from a list of nearby items, then press continue.

3. When the following page is displayed, press the button on the Scout, then select "Continue On Website".

4. A page similar to this should be displayed with the Scout serial number. If the device has been set to lost mode, a message and contact details from the owner may also be displayed here.

DESIGNED BY KNOG MELBOURNE, AUSTRALIA

2 YEAR WARRANTY

KNOG.COM

